



Landscape development application

Catholic Schools Office Maitland-Newcastle
 St Michaels Nelson Bay rev E
 12 Sproule Street, Nelson Bay

Pathway through
native mass planting bed

Paved shared surface
as congregation area

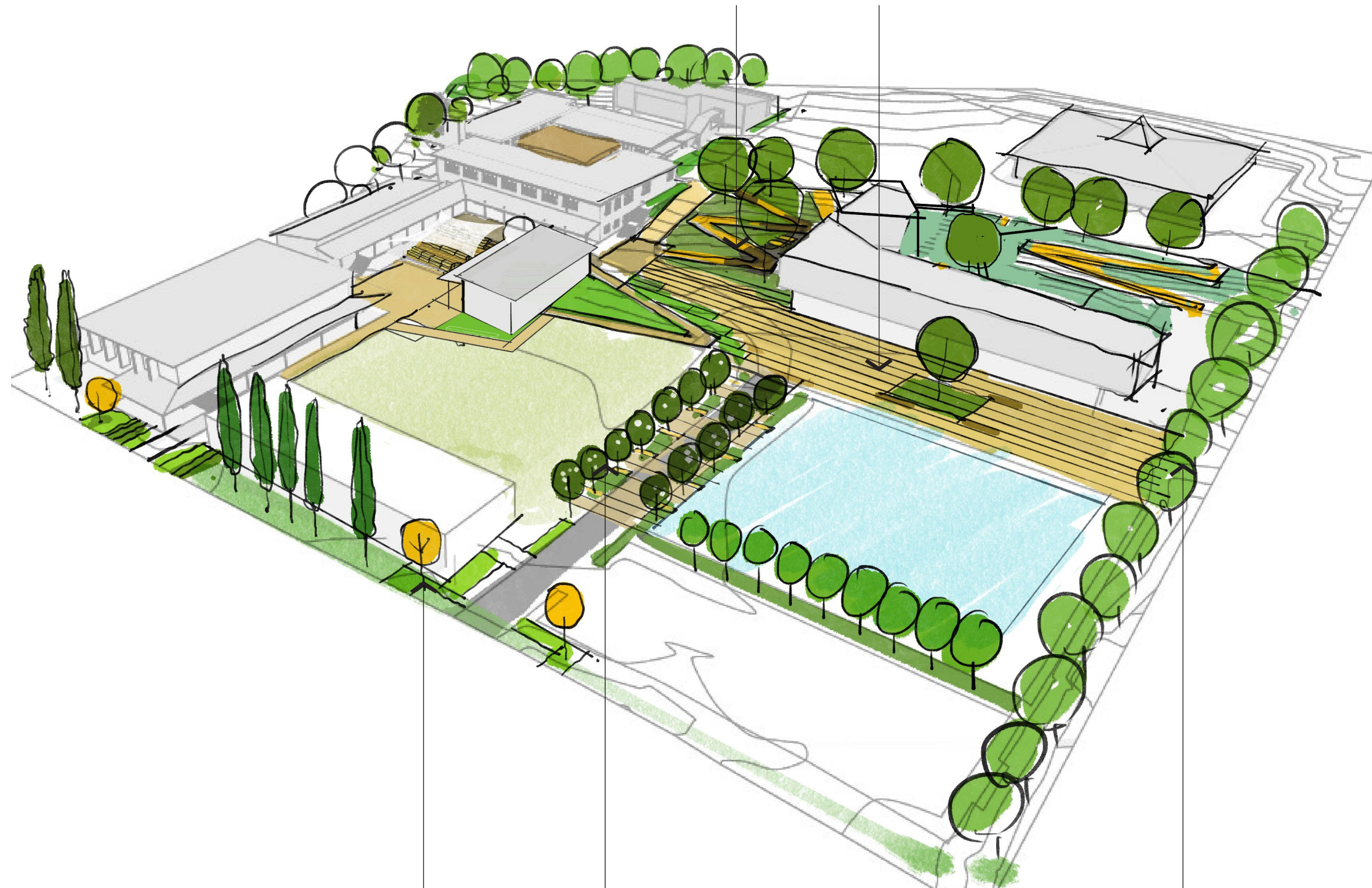

New Entry
statement

New tree
avenue as shared zone

Landscape buffer
to residence

G	28/09/2022	ISSUE TO CLIENT
F	15/06/2022	ISSUE TO CLIENT
E	31/01/2022	ISSUE TO CLIENT
D	29/09/2020	ISSUE TO CLIENT
REV	DATE	COMMENTS

PROJECT:
St Michaels Nelson Bay

DRAWING:
Landscape sketch

SITE:
12 Sproule St, Nelson bay

CLIENT:
**Catholic Schools Office
Maitland-Newcastle**

DRAWN: MA/AL DATE: 31/01/2022 SCALE:
JOB NUMBER: 13099.5 PHASE: DA DWG No: L01 REV: F



terras
landscape architects

412 KING STREET NEWCASTLE NSW AUSTRALIA 2300
TERRAS.COM.AU PH: 49 294 926 FAX: 49 263 069

concept sketches | 02

Concept images



Entry avenue trees



Pathway with perforated FRP deck in tree protection zone



Courtyard with outdoor classroom



Courtyard with outdoor classroom



Courtyard with outdoor classroom

G	28/09/2022	ISSUE TO CLIENT
F	15/06/2022	ISSUE TO CLIENT
E	31/01/2022	ISSUE TO CLIENT
D	29/09/2020	ISSUE TO CLIENT
REV	13/08/2020	ISSUE TO CLIENT
DATE	COMMENTS	

PROJECT:
St Michaels Nelson Bay

DRAWING:
Concept images

SITE:
12 Sproule St, Nelson bay

CLIENT:
**Catholic Schools Office
Maitland-Newcastle**

DRAWN: MA/AL DATE: 31/01/2022 SCALE:
JOB NUMBER: 13099.5 PHASE: DA L02 DWG No: F

terras
landscape architects
412 KING STREET NEWCASTLE NSW AUSTRALIA 2300
TERRAS.COM.AU PH: 49 294 926 FAX: 49 263 069

concept sketches | 03

landscape layout

Screen and infill planting between classrooms and carpark to consist of Syzygium, Banksia, Westringia, Lomandra and Myoporum.

Amphitheatre seating with landscape around. Species to include Grevillea, Callistemon, Lomandra and Myoporum.

Landscape buffer to residences to include Melaleuca, Syzygium, Callistemon, Westringia.

New pavement with outdoor classroom and shade sail

Informal learning area & vegetable garden. Plant selection by school.

Sandstone seating & platforms

Sandstone block edge between play ground and paved court

Araucaria heterophylla to continue street trees



Screen planting to rear to consist of Syzygium and Banksia. Banding of plants to include Metrosideros, Grevillea, Westringia, Lomandra, Poa, Pennisetum.

Dicksonia in shade areas

Early education centre outdoor play area

Pathway through native mass planting bed

Landscape buffer to residences to include Elaeocarpus, Syzygium, Callistemon and infill smaller shrubs and grasses

Liquidambar feature tree

Paved shared surface as congregation area

Pathway within turfed batter

New surface & marking to Basketball and multiplay area

New tree avenue (Lagerstroemia) with paved shared surface

New tree line (Tristanopsis 'Luscious') between parking & basketball area

Existing trees to be retained.

New Entry statement

REV	DATE	COMMENTS
G	28/09/2022	ISSUE TO CLIENT
F	15/06/2022	ISSUE TO CLIENT
E	31/01/2022	ISSUE TO CLIENT
D	29/09/2020	ISSUE TO CLIENT
C	13/08/2020	ISSUE TO CLIENT

PROJECT:
St Michaels Nelson Bay

DRAWING:
Landscape plan

SITE:
12 Sproule St, Nelson bay

CLIENT:
**Catholic Schools Office
Maitland-Newcastle**

DRAWN: MA/AL DATE: 31/01/2022 SCALE:
JOB NUMBER: 13099.5 PHASE: DA DWG No: L03 REV: F

concept sketches | 03

tree removal - retention plan

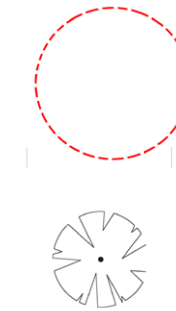

TREES TO BE REMOVED

EXISTING TREES RETAINED

G	28/09/2022	ISSUE TO CLIENT
F	15/06/2022	ISSUE TO CLIENT
E	31/01/2022	ISSUE TO CLIENT
D	29/09/2020	ISSUE TO CLIENT
C	13/08/2020	ISSUE TO CLIENT
REV	DATE	COMMENTS

PROJECT:
St Michaels Nelson Bay

DRAWING:
Tree removal retention plan

SITE:
12 Sproule St, Nelson bay

CLIENT:
**Catholic Schools Office
Maitland-Newcastle**

DRAWN: MA/AL DATE: 31/01/2022 SCALE:
JOB NUMBER: 13099.5 PHASE: DA L03 REV: F



terras
landscape architects
412 KING STREET NEWCASTLE NSW AUSTRALIA 2300
TERRAS.COM.AU PH: 49 294 926 FAX: 49 263 069

concept sketches | 04

landscape layout: 1



concept sketches | 05

landscape layout: 2



Screen and infill planting between classrooms and carpark to consist of Syzygium, Banksia, Westringia, Lomandra and Myoporum.

Amphitheatre seating with landscape around. Species to include Grevillea, Callistemon, Lomandra and Myoporum.

New pavement with outdoor classroom and shade sail

Informal learning area & vegetable garden

Screen planting to rear to consist of Syzygium and Banksia. Banding of plants to include Metrosideros, Grevillea, Westringia, Lomandra, Poa, Pennisetum.

Entry to play area through ramp

Early education centre outdoor play area

Detail layout in L08

Landscape buffer to residences to include Elaeocarpus, Syzygium, Callistemon and infill smaller shrubs and grasses

REV	DATE	COMMENTS
G	28/09/2022	ISSUE TO CLIENT
F	15/06/2022	ISSUE TO CLIENT
E	31/01/2022	ISSUE TO CLIENT
D	29/09/2020	ISSUE TO CLIENT
C	13/08/2020	ISSUE TO CLIENT

PROJECT:
St Michaels Nelson Bay

DRAWING:
Concept layout :part 2

SITE:
12 Sproule St, Nelson bay

CLIENT:
**Catholic Schools Office
Maitland-Newcastle**

DRAWN: MA/AL DATE: 31/01/2022 SCALE:
JOB NUMBER: 13099.5 PHASE: DA DWG No: L05 REV: F



terras
landscape architects

412 KING STREET NEWCASTLE NSW AUSTRALIA 2300
TERRAS.COM.AU PH: 49 294 926 FAX: 49 263 069

concept sketches | 06

layout:ramp area



Screen planting to rear to consist of Syzygium and Banksia. Banding of plants to include Metrosideros, Grevillea, Westringia, Lomandra, Poa, Pennisetum.

Existing trees retained

bridge Entry to EEC refer architecture

Fixed seating within mass planting area

Elevated Pathway through native mass planting bed to prevent harm to tree root zone.

G	28/09/2022	ISSUE TO CLIENT
F	15/06/2022	ISSUE TO CLIENT
E	31/01/2022	ISSUE TO CLIENT
D	29/09/2020	ISSUE TO CLIENT
REV	DATE	COMMENTS

PROJECT:
St Michaels Nelson Bay

DRAWING:
Concept layout

SITE:
12 Sproule St, Nelson bay

CLIENT:
**Catholic Schools Office
Maitland-Newcastle**

DRAWN: MA/AL DATE: 31/01/2022 SCALE:
JOB NUMBER: 13099.5 PHASE: DA L06 REV: F



terras
landscape architects

412 KING STREET NEWCASTLE NSW AUSTRALIA 2300
TERRAS.COM.AU PH: 49 294 926 FAX: 49 263 069

concept sketches | 07

layout:courtyard area



New pavement
with outdoor
classroom and shade
sail

Outdoor classroom,
flexible spaces

Shade sail above

Synthetic turf area

REV	DATE	COMMENTS
G	28/09/2022	ISSUE TO CLIENT
F	15/06/2022	ISSUE TO CLIENT
E	31/01/2022	ISSUE TO CLIENT
D	29/09/2020	ISSUE TO CLIENT
C	13/08/2020	ISSUE TO CLIENT

PROJECT:
St Michaels Nelson Bay

DRAWING:
Concept layout

SITE:
12 Sproule St, Nelson bay

CLIENT:
**Catholic Schools Office
Maitland-Newcastle**

DRAWN: MA/AL DATE: 31/01/2022 SCALE:
JOB NUMBER: 13099.5 PHASE: DA L07 REV: F



terras
landscape architects

412 KING STREET NEWCASTLE NSW AUSTRALIA 2300
TERRAS.COM.AU PH: 49 294 926 FAX: 49 263 069

NOTES

1. Emergency egress ramp to architectural documentation
2. 900mm palisade fence
3. 1500mm balustrade fence
4. 2100 timber palisade fence
5. Gate
6. Timber swing frame with mulch fallzone
7. Balancing / sitting log
8. Stepping stones through sensory planting
9. Sandstone log sandpit with shade sail over
10. Storage shed under decking
11. Sandstone retaining wall as required
12. Timber stilts
13. Bamboo tunnel
14. Terraced sandstone logs for seating and play
15. Mulch slope with timber balancing and play elements
16. Timber cubby tower with mulch fallzone
17. Mud pit with rock edge
18. Mulch slope with timber and sandstone balancing and play elements
19. Mass planting to lower level
20. Water play
21. Deck to architectural documentation

LEGEND

- 2100mm timber acoustic fence
- 1200mm fence
- 900mm fence
- Sandstone log
- Playground mulch
- Fallzone
- Mud pit
- Paths
- Log edge / step
- Water play
- Natural play elements
- Planting
- Sandstone log wall (SL)
- Steppers
- Decking
- Veggie garden
- Playground sand
- Artificial turf
- Shade sail
- Shade tree

G	28/07/2022	ISSUE TO CLIENT
F	15/06/2022	ISSUE TO CLIENT
E	31/01/2022	ISSUE TO CLIENT
D	29/09/2020	ISSUE TO CLIENT
REV	DATE	COMMENTS

PROJECT:
St Michaels Nelson Bay

DRAWING:
Concept layout

SITE:
12 Sproule St, Nelson bay

CLIENT:
**Catholic Schools Office
Maitland-Newcastle**

DRAWN: MA/AL DATE: 31/01/2022 SCALE:
JOB NUMBER: 13099.5 PHASE: DA L08 DWG No: F

terras
landscape architects
412 KING STREET NEWCASTLE NSW AUSTRALIA 2300
TERRAS.COM.AU PH: 49 294 926 FAX: 49 263 069



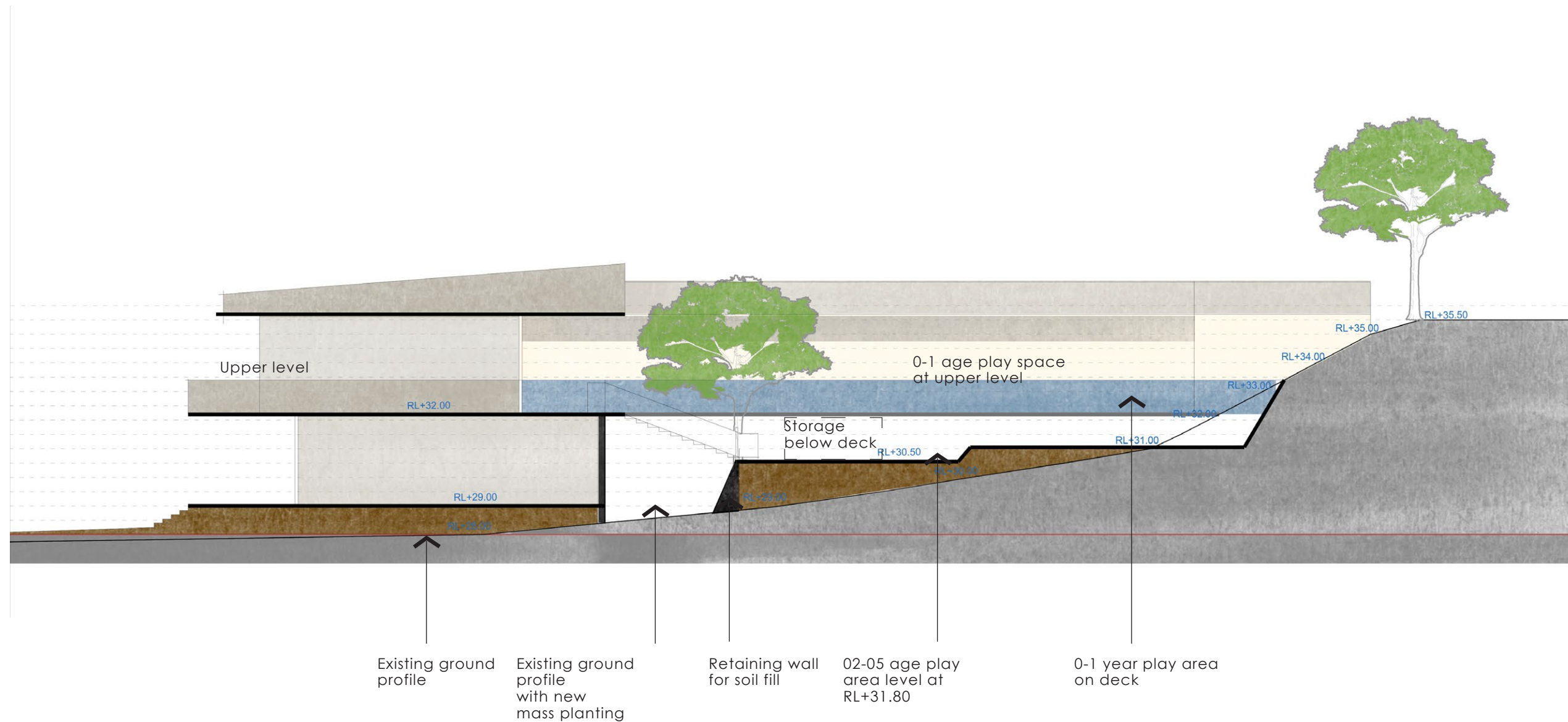

G	28/09/2022	ISSUE TO CLIENT
F	15/06/2022	ISSUE TO CLIENT
E	31/01/2022	ISSUE TO CLIENT
D	29/09/2020	ISSUE TO CLIENT
	13/08/2020	ISSUE TO CLIENT
REV	DATE	COMMENTS

PROJECT:
St Michael's Nelson Bay

DRAWING:
Concept section

SITE:
12 Sproule St, Nelson bay

CLIENT:
**Catholic Schools Office
Maitland-Newcastle**

DRAWN: MA/AL DATE: 31/01/2022 SCALE:
JOB NUMBER: 13099.5 PHASE: DA DWG No: L09 REV: F

concept sketches | 10

concept images



Play area- wooden play



Play area- planks and rope course



Using sandstone steps to create platform



G	28/09/2022	ISSUE TO CLIENT
F	15/06/2022	ISSUE TO CLIENT
E	31/01/2022	ISSUE TO CLIENT
D	29/09/2020	ISSUE TO CLIENT
	13/08/2020	ISSUE TO CLIENT
REV	DATE	COMMENTS

PROJECT:
St Michaels Nelson Bay

DRAWING:

SITE:
12 Sproule St, Nelson bay

CLIENT:
**Catholic Schools Office
Maitland-Newcastle**

DRAWN: MA/AL DATE: 31/01/2022 SCALE:
JOB NUMBER: 13099.5 PHASE: DA DWG No: L10 REV: F



Lagerstroemia indica



Araucaria heterophylla



Trisataniopsis laurina 'Luscious'



Dicksonia antarctica



Melaleuca linarifolia



Gardenia augusta florida



Dietes iridioides



Westringia fruticosa



Liquidambar styraciflua

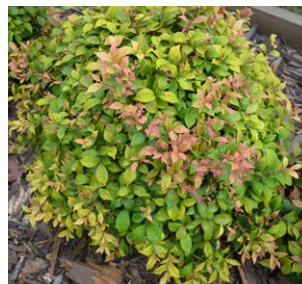

Acmena 'Allyn Magic'

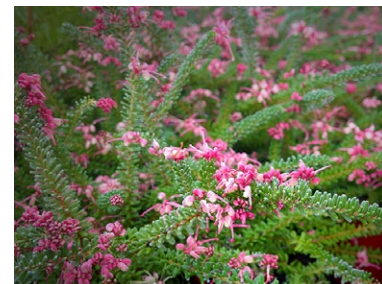

Grevillea lanigera 'Mount Tamboritha'



Banksia spinulosa 'Birthday Candles'



Myoporum parvifolium

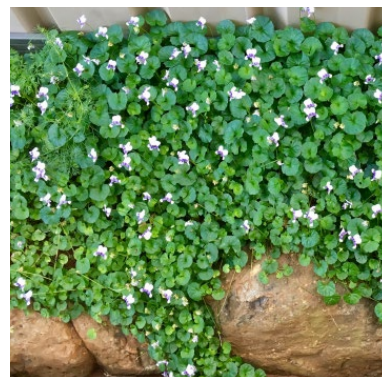

Viola hederacea



Liriope muscari 'Isabella'



Lomandra longifolia



Thymus x citriodorus



Rosemarinus officinalis

Suggested Plant Schedule

Trees			
	Botanical Name	Common Name	Spacing
	<i>Araucaria heterophylla</i>	Norfolk Island Pine	
	<i>Dicksonia antarctica</i>	Tasmanian Tree Fern	
	<i>Elaeocarpus reticulatus</i>	Blueberry Ash	
	<i>Lagerstroemia indica</i>	Crepe-Myrtle	
	<i>Liquidambar styraciflua</i>	Sweet Gum	
	<i>Melaleuca linarifolia</i>	Snow In Summer	
	<i>Trisataniopsis laurina</i> 'Luscious'	Water Gum	
Shrubs			
	<i>Acmena</i> 'Allyn Magic'	Dwarf Lilly Pilly	0.8m ctrs
	<i>Banksia spinulosa</i> 'Birthday Candles'	Birthday Candles Banksia	1m ctrs
	<i>Callistemon</i> .cvs	Bottlebrush	
	<i>Dietes iridioides</i>	Dietes	0.8m ctrs
	<i>Gardenia augusta florida</i>	Gardenia	1m ctrs
	<i>Grevillea</i> 'Moonlight'	Moonlight	3m ctrs
	<i>Grevillea</i> 'Peaches and Cream'	Peaches and Cream	2m ctrs
	<i>Grevillea</i> 'Robyn Gordon'	Robyn Gordon	1.5m ctrs
	<i>Grevillea</i> 'Mt Tamboritha'	Grevillea	1.5m ctrs
	<i>Metrosideros</i> 'Mini Christmas'	Dwarf NZ Christmas Bush	0.9m ctrs
	<i>Metrosideros</i> 'Tahiti'	Dwarf NZ Christmas Bush	0.9m ctrs
	<i>Syzygium</i> 'Resilience'	Resilience	1.5m ctrs
	<i>Teucrium fruticans</i>	Germander	1.2m ctrs
	<i>Westringia fruticosa</i>	Coastal Rosemary	1.2m ctrs
Grasses, Groundcovers and Herbs			
	<i>Dichondra</i> 'Silver Falls'	Silver Dichondra	1m ctrs
	<i>Liriope muscari</i> 'Isabella'	Isabella	0.3m ctrs
	<i>Lomandra longifolia</i>	Mat Rush	0.9m ctrs
	<i>Lomandra</i> 'Seascape'	Seascape	0.8m ctrs
	<i>Lomandra</i> 'Tanika'	Tanika	0.8m ctrs
	<i>Myoporum parvifolium</i>	Creeping Boobialla	1m ctrs
	<i>Rosmarinus officinalis</i>	Rosemary	0.8m ctrs
	<i>Thymus x citriodorus</i>	Lemon Thyme	0.5m ctrs
	<i>Viola hederacea</i>	Native Violet	0.3m ctrs
	<i>Westringia</i> 'Low Horizon'	Groundcover Coast Rosemary	1m ctrs
	<i>Pennisetum alopecuroides</i>	Swamp Fox Tail	0.8m ctrs
	<i>Poa labillardierei</i>	Tussock Grass	0.8m ctrs
	<i>Carpobrotus glaucescens</i>	Pigface	1m ctrs

G	28/09/2022	ISSUE TO CLIENT
F	15/06/2022	ISSUE TO CLIENT
E	31/01/2022	ISSUE TO CLIENT
D	29/09/2020	ISSUE TO CLIENT
REV	DATE	COMMENTS

PROJECT:
St Michaels Nelson Bay

DRAWING:

SITE:
12 Sproule St, Nelson bay

CLIENT:
Catholic Schools Office
Maitland-Newcastle

DRAWN: MA/AL DATE: 31/01/2022 SCALE:
JOB NUMBER: 13099.5 PHASE: DWG No: DA L11 REV: F



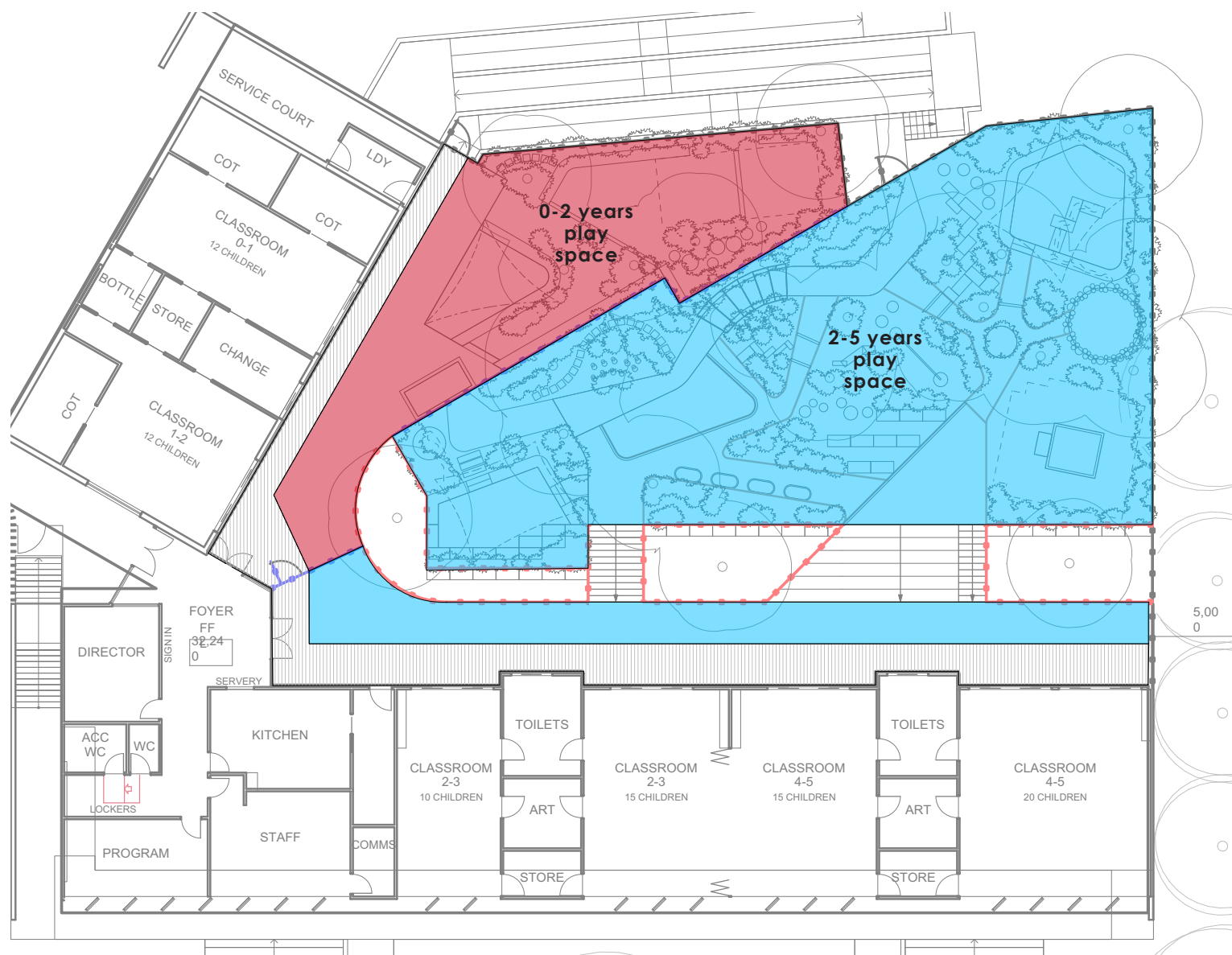

Unencumbered play space areas			
AGE GROUP	NUMBER OF CHILDREN	AREA REQUIRED (7m² x #)	AREA PROVIDED
0 - 2 YEARS	24	168	168
2 - 5 YEARS	60	420	481
TOTAL	84	588	649

G	28/09/2022	ISSUE TO CLIENT
F	15/06/2022	ISSUE TO CLIENT
E	31/01/2022	ISSUE TO CLIENT
D	29/09/2020	ISSUE TO CLIENT
REV	DATE	COMMENTS

PROJECT:
St Michael's Nelson Bay

DRAWING:
Landscape area

SITE:
12 Sproule St, Nelson bay

CLIENT:
Catholic Schools Office
Maitland-Newcastle

DRAWN: MA/AL DATE: 31/01/2022 SCALE:
JOB NUMBER: 13099.5 PHASE: DA L12 REV: F



date: 5/10/2022
project no: 13099.5
to: PORT STEPHENS COUNCIL
address: C/- CKDS ARCHITECTURE
attention: Ben Rapley
email: brapley@ckds.com.au

design statement

St Michaels School – Nelson Bay Offset Planting.

Dear Ben

We refer to the project for proposed new works for the St Michaels school upgrades at Sproule Street, Nelson Bay. Terras landscape architects have prepared the design concepts for the external area landscaping associated with these new works. Terras Ref 13099.5-DA-Rev F Sheets. L01 – L12.

We note the Councils request to ensure that adequate offset planting:

'.....written detail be provided to confirm the offset planting is sufficient in terms of replacement numbers and comment from a suitably qualified arborist as to whether any additional trees would be impacted by the installation of acoustic fences'

We confirm that offset planting of canopy trees proposed in the landscape plan is significantly greater than trees removed as part of this submission.

Terras drawing L03A – Tree Removal, Retention Plan clearly indicates the trees to be retained and trees to be removed. All information is based on survey data. A total of two large and three medium trees are to be removed. All other trees to be retained have been provided with adequate retention space and offsets. No fencing will impact existing trees.



Australian Institute of
Landscape Architects

Principals:
Phillip Williams
Steven Rushworth
Guy Frostick
Kate Hopoi

ABN:
67 129 348 842

Phone:
+61 02 49294926

Email:
admin@terras.com.au

Address:
412 King St
Newcastle NSW 2300

Web:
www.terras.com.au

Sheet L03 shows the proposed new tree planting [inset provided below, shown as purple]. Approximately 50 new trees are to be planted.



Yours faithfully,

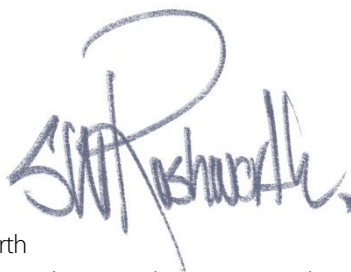

Steven Rushworth

AILA Registered Landscape Architect – Horticulturist AILA MAIH

Director

Terras Landscape Architects



Principals:

Phillip Williams
Steven Rushworth
Guy Frostick
Kate Hopoi

ABN:

67 129 348 842

Phone:

+61 02 49294926

Email:

admin@terras.com.au

Address:

412 King St
Newcastle NSW 2300

Web:

www.terras.com.au